

P25943 **FILE**

FILE

17 June 1996

Copy to: 6553/235.00A

Please Quote: ~~6506055~~

Ref: esl706b.jwt

Martin McCaulay Morton
Surveyors
PO Box 878
ROTORUA

Attn: Bart Yetsenga

Dear Sir

APPLICATION FOR SUBDIVISION CONSENT - GREGOR
196 CLAYTON ROAD, MANGAKAKAHI

At its meeting on 14 June 1996, Council resolved that the application for the subdivision of Lot 23 DPS 911 Block IV Horohoro S.D. approved in terms of Section 104, 105 and 108 of the Resource Management Act 1991 subject to the following conditions:

- i) That the vehicle crossing to serve the proposed Lot 2 is formed, drained and constructed in accordance with Council's Engineering Code of Practice and District Plan.
- ii) That Lots 1 & 2 are each provided with a separate sanitary sewerage connection and pipes to the new polypropylene inspection chamber and the appropriate easement over the pipe be provided to the satisfaction of the District Engineer.
- iii) That the vehicle crossing to be constructed is in a location which does not affect the street tree in the grass verge on Lisa Cres.

Yours faithfully

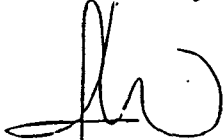

Joanne Watts
Planner

DISCLAIMER: - MARTIN McCRAULAY MORTON LTD
THIS DOCUMENT SHALL BE USED ONLY FOR THE PURPOSE FOR WHICH IT WAS SUPPLIED AND MUST NOT BE USED IN RELATION TO ANY OTHER ASSOCIATED INFORMATION.

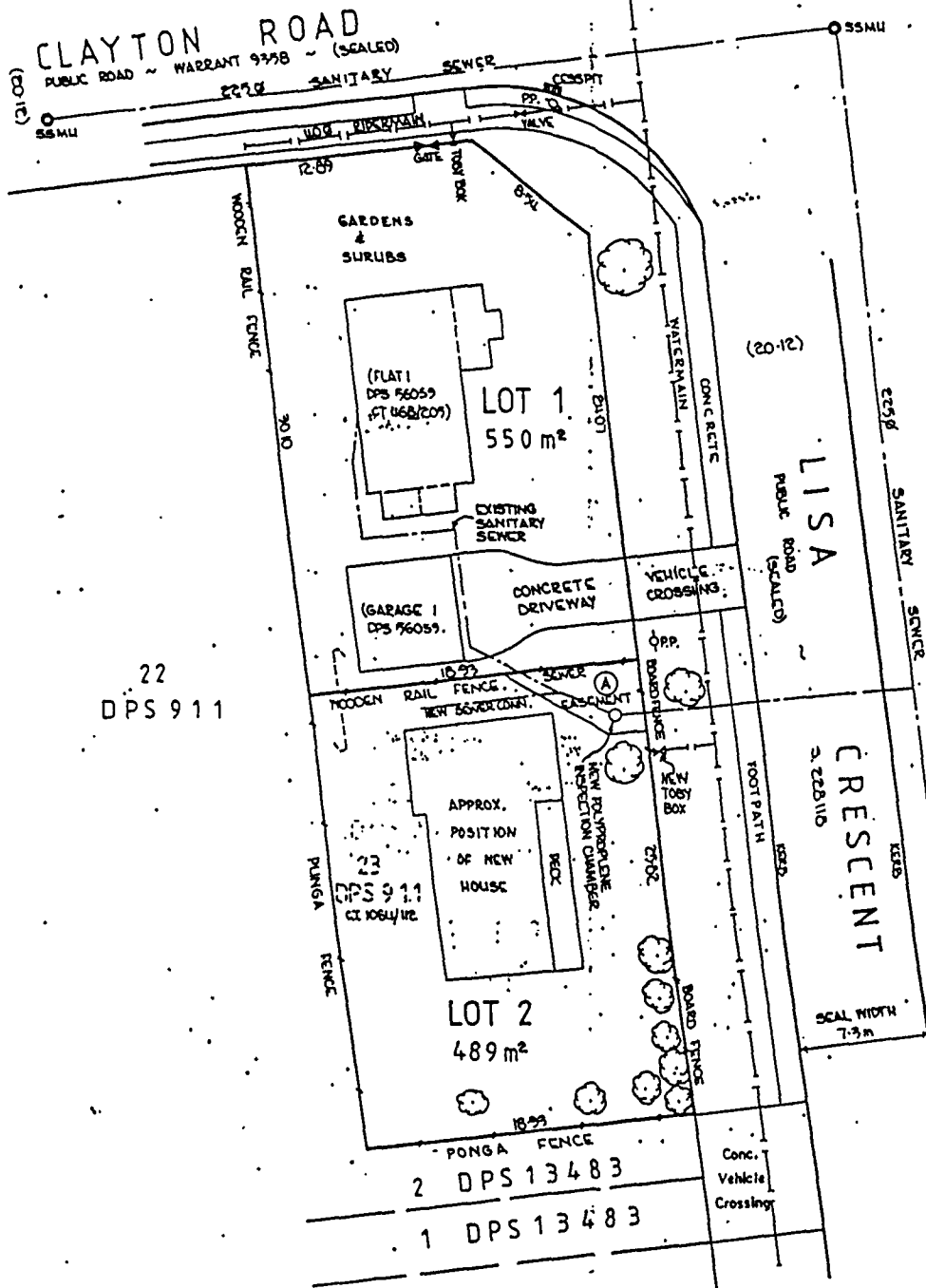

MEMORANDUM OF EASEMENT			
PURPOSE	DOMINANT TENEMENT	SUBJECT TENEMENT	COMMENTS
RIGHT TO DRAIN SEWAGE	LOT 2	(A)	LOT 1

SOUTH AUCKLAND LAND DISTRICT
BLOCK IV HOROHORO S.D.
ROTORUA DISTRICT COUNCIL
U.16 / 45.05

PLAN PREPARED FOR: C. GREGOR
ADDRESS: 196 CLAYTON ROAD
ROTORUA.

C.T. 46B / 205, C.T. 1064 / 112

NOTE: AREAS AND MEASUREMENTS ARE
SUBJECT TO SURVEY.

REDUCED COPY
NOT ORIGINAL SCALE

APPROVED
DATE 14/6/96

MARTIN McCRAULAY MORTON LTD
REGISTERED SURVEYORS, CIVIL ENGINEERS, TOWN PLANNERS

PROPOSED SUBDIVISION OF LOT 23 DPS 911.

SCALE 1:200		FILE 83577/P
DATE FEB. 1996	Drawn BY Checked BY	
		SHEET 1 OF 1